



## SF200

Access Control  
Biometric Fingerprint Device



## Features

### Standard Features

- Reliable, durable & highly accurate ZK optical
- Built-in Serial and Ethernet ports
- Built-in Wiegand output port
- 2-inch colour display
- Stores 1500 templates and 80,000 transactions
- Reads Fingerprint and/or Pin's and/or RFID card

### Enhanced Features

- Built-in auxiliary input for linkage functions
- Up to 15 multi-verification methods
- Tamper switch
- Duress Alarm

### Software

- ZK Access Control Management 3.5
- ZKTime.net (T&A)

### Related Products



ZK4500



Maglocks



RFID Cards



Exit Button

### Alternative Products



SF100



SF300



## Specifications

- Fingerprint Capacity: 1,500 templates
- Transaction Capacity: 80,000 transactions
- RFID Card Capacity: 5,000 cards
- Sensor: ZK Optical Sensor
- Algorithm Version: ZK Finger v10.0
- Built-in Card Reader: 125kHz RFID proximity reader
- Communication: RS485, TCP/IP
- Wiegand Ports: Output
- Auxilliary Input: 1 each for linkage function
- Access Control interfaces: 3rd party electric lock, door sensor, exit button, door alarm
- Power Supply: 12V DC 3A
- Operating Temperature: 0 °C - 45 °C
- Operating Humidity: 20%-80%
- Dimension: 91 X 188 X 38mm

## Dimensions

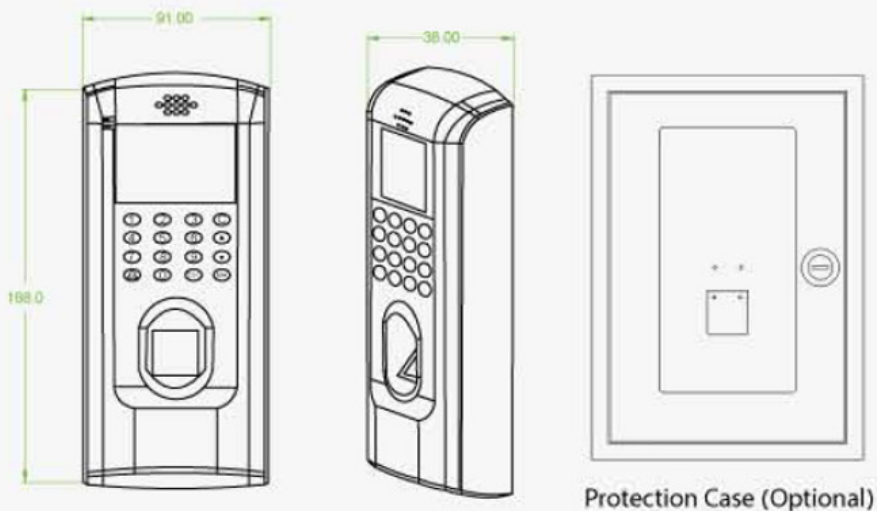

## Configuration

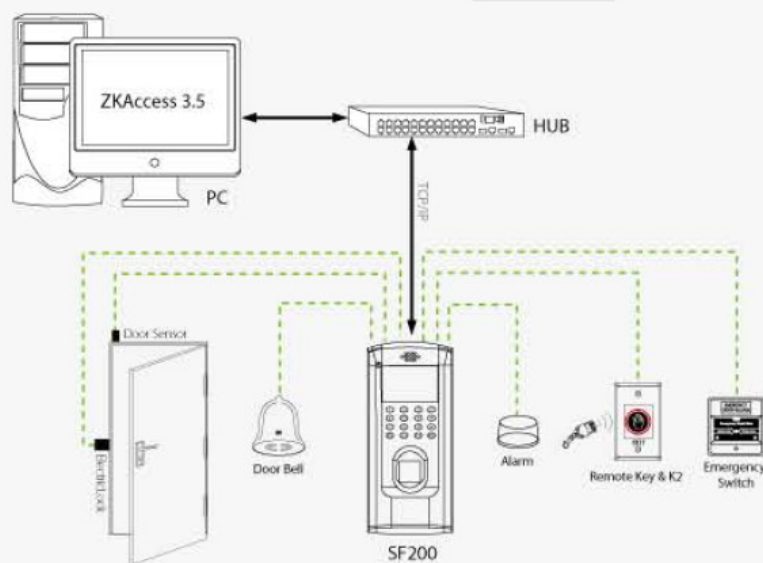

ZKTeco, ZKSoftware, ZKAccess, ZKIVision, ZKBioblock, ZKAFIS are either registered trademarks or trademarks of ZKTECO INC and ZKTeco South Africa.

You must obtain written and signed permission from ZKTECO before using any photograph owned or licenced by ZKTECO.

Copyright © 1998-2014 ZKTECO INC. All rights reserved.