

G2

Fingerprint Time Attendance & Access Control Terminal



G2 fingerprint identification terminal features ZKTeco's innovative Silk ID fingerprint sensor. With 3D Neuron Fingerprint Verification Sensor-Activation and Anti-Interference technology, it precisely detects dry, wet, and rough fingerprints, and operates well under strong sunlight environment. With the latest core-board, the fingerprint capacity is enlarged to 20,000.

Features



Modern Design & Interactive UI



Revolutionary SilkID Fingerprint Sensor



Multiple Verification Modes: Fingerprint / Card / Password



Outstanding Performance With Dry, Wet and Rough Fingers



Optional Wi-Fi or 3G

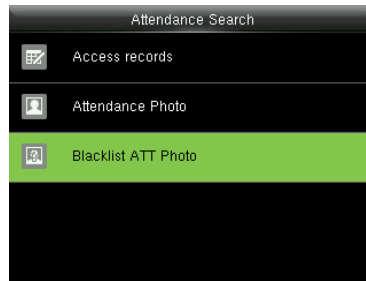
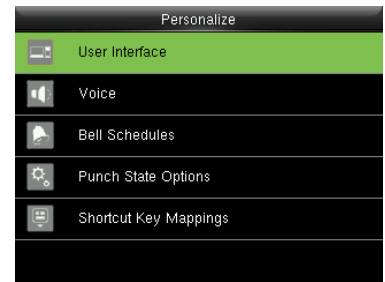

Specifications G: GL Exclusive Feature

Capacity

Fingerprints	20,000 (Standard)
	40,000 (Optional)
Cards	20,000
Transactions	200,000

Communication

TCP/IP
USB Host
Wiegand Input / Output

Access Control Interface

Lock Relay Output
Alarm Output
Exit Button
Door Sensor
External Bell Output

Hardware

- G 1.2GHz High Speed CPU
- G Memory 128MB RAM / 256MB Flash
- SilkID Fingerprint Sensor
- 3.5 Inches TFT-LCD Screen
- Hi-Fi Voice & Indicator
- Tamper Switch Alarm

Standard Functions

ID Card / Work Code / WDMS
DST / SMS / Bell Schedule
Attendance Status Auto-Switch
Record Query / Photo ID
Anti-Passback
Custom Wallpaper & Screen Saver

Optional Functions:

- HID Proxy / Mifare Card Reader
- External Printer
- G Wi-Fi / 3G

Special Functions

- G Multiple Verification Modes
- G Alive Finger Detection

Compatibility

ZKTime.Web
ZKTime.Net 3.0
ZKAccess 3.5
WDMS

Additional Info

Working Temperature: 0 °C ~ 45 °C
Dimensions: 206.0 × 153.0 × 42.9 mm
Fingerprint Algorithm ZKFinger v10.0
FAR≤0.0001% FRR≤0.01%

Power

Operating Voltage 12V DC
Current Draw < 500 mA

Configuration

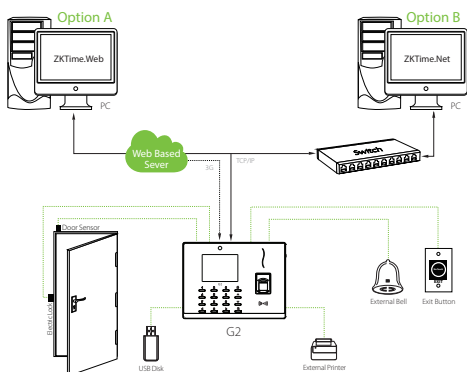

Dimensions (mm)

