

DS-2CD2D21G0(/M)-D/NF 2 MP Mini Network Camera



Without /M model



With /M model



Key Features

- 1/2.7" Progressive Scan CMOS
- 1920 × 1080@30 fps
- H.265+, H.265, H.264+, H.264
- 6 Behavior analyses, 2 exception detections and face detection
- 3D DNR/ROI
- Support NAS (NFS, SMB/CIFS)
- 120dB WDR



Specifications

Camera	
Image Sensor	1/2.7" Progressive Scan CMOS
Min. Illumination	Without /M model: Color: 0.025 Lux @ (F1.2, AGC ON), Color: 0.109 Lux @ (F2.5, AGC ON) B/W: 0.005 Lux @ (F1.2, AGC ON), B/W: 0.022 Lux @ (F2.5, AGC ON) With /M model: Color: 0.025 Lux @ (F1.2, AGC ON), Color: 0.069 Lux @ (F2.0, AGC ON) B/W: 0.005 Lux @ (F1.2, AGC ON), B/W: 0.014 Lux @ (F2.0, AGC ON)
Shutter Speed	1/3 s to 1/100,000 s
Slow Shutter	Yes
Auto-Iris	No
Day & Night	Electronic
Digital Noise Reduction	3D DNR
WDR	120dB
Lens	
Focal Length	Without /M model: 3.7 mm With /M model: 2.8 mm, 4 mm
Focus	Fixed
FOV	Without /M model: 3.7 mm horizontal FOV: 78°, vertical FOV: 43°, diagonal FOV: 90° With/M model: 2.8 mm horizontal FOV: 114°, vertical FOV: 62°, diagonal FOV: 135° 4 mm horizontal FOV: 86°, vertical FOV: 46°, diagonal FOV: 102.5°
Lens Mount	M12
Compression Standard	
Video Compression	H.265/H.264/MJPEG
H.264 Type	Baseline Profile/Main Profile/High Profile
H.264+	Yes
H.265 Type	Main Profile
H.265+	Yes
Video Bit Rate	32 Kbps to 8 Mbps
Smart Feature-set	
Behavior Analysis	Line crossing detection, intrusion detection, region entrance detection, region exit detection, unattended baggage detection, object removal detection
Exception	Scene change detection, defocus detection
Face Detection	Yes
Region of Interest	Support 1 fixed region for main stream, sub-stream and third stream
Image	
Max. Resolution	1920 × 1080
Main Stream	50Hz: 25fps (1920 × 1080, 1280 × 960, 1280 × 720) 60Hz: 30fps (1920 × 1080, 1280 × 960, 1280 × 720)
Sub-Stream	50Hz: 25fps (704 × 576, 640 × 480, 352 × 288) 60Hz: 30fps (704 × 480, 640 × 480, 352 × 240)
Third Stream	50Hz: 1fps (1920 × 1080, 1280 × 960, 1280 × 720, 704 × 576, 640 × 480)

	60Hz: 1fps (1920 × 1080, 1280 × 960, 1280 × 720, 704 × 480, 640 × 480)
Image Enhancement	3D DNR
Image Settings	Rotate mode, saturation, brightness, contrast, sharpness adjustable by client software or web browser
Day/Night Switch	Day/Night/Auto/Schedule
Network	
Network Storage	Support NAS (NFS, SMB/CIFS)
Alarm Trigger	Motion detection, video tampering, IP address conflict, illegal login
Protocols	TCP/IP, ICMP, HTTP, HTTPS, FTP, DHCP, DNS, DDNS, RTP, RTSP, RTCP, PPPoE, NTP, UPnP™, SMTP, SNMP, IGMP, 802.1X, QoS, IPv6, Bonjour
General Function	Anti-flicker, heartbeat, mirror, password protection, privacy mask, watermark, IP address filter
API	ONVIF (PROFILE S, PROFILE G), ISAPI
Simultaneous Live View	Up to 6 channels
User/Host	Up to 32 users 3 levels: Administrator, Operator and User
Client	iVMS-4200, Hik-Connect, iVMS-5200, iVMS-4500
Web Browser	IE8+, Chrome 31.0-44, Firefox 30.0-51, Safari 8.0+
Interface	
Audio	1 input (line in)
Communication Interface	1 RJ45 10M/100M self-adaptive Ethernet port
Reset Button	Yes
General	
Operating Conditions	-30 °C to +60 °C (-22 °F to +140 °F), Humidity 95% or less (non-condensing)
Power Supply	12 VDC ± 20%, Φ 5.5 mm coaxial plug power
Power Consumption and Current	12 VDC, 0.3 A, max. 3 W
Material	Aluminum Alloy
Dimensions	Without /M model: 31 mm × 31 mm × 26 mm (1.2" × 1.2" × 1") With /M model: 31 mm × 31 mm × 39 mm (1.2" × 1.2" × 1.5")
Weight	With package: approx. 202 g (0.4 lb.) Camera: approx. 93 g (0.2 lb.)

Available Models:

DS-2CD2D21G0/M-D/NF(2.8 mm) DS-2CD2D21G0/M-D/NF(4 mm), DS-2CD2D21G0-D/NF(3.7mm)

Dimensions

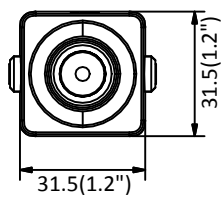

Without /M Model

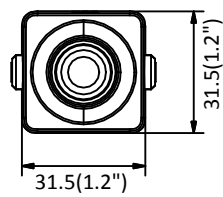
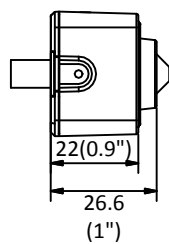

With /M Model

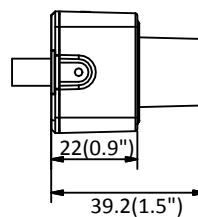

Unit: mm (inch)