

TAP-15

RECESSED CONTACTS

.25"(6.4mm) Recessed Type



Contact Size: .25"×1.06"(6.4mm×26.9mm)

Standard Magnet Size: .25"×1"(6.35mm×25.4mm)

Standard Gap: .6"(15mm)

Colors: White, Brown

12"(305mm) 22 AWG Leads Standard

Longer leads available.

Specifications

Part Number	Gap Inch(mm)	Loop Open/Closed	Reed Form	Max. Contact Rating (W)	Max. Initial Contact Resistance (mΩ)	Max. Switching Voltage (V)	Max. Switching Current (A)
TAP-15	.6"(15)	CLOSED	Normally Open	10	100	AC110/DC100	0.5
* TAP-16B Special Order	.5"(12.5)	OPEN	Normally Closed	3	100	AC30/DC30	0.2
* TAP-15 WG Special Order	1.26"(32)	CLOSED	Normally Open	10	100	AC110/DC100	0.5
* TAP-17C Special Order	.5"(12.5)	SPDT	SPDT	3	100	AC30/DC30	0.2

OPERATING TEMPERATURE:-40°C to +60°C

*SPECIAL ORDER - Call for Min. Order Qty. - Leadtime - Pricing

Outline Dimensions

Unit: inch(mm)

TAP-15/TAP-16B

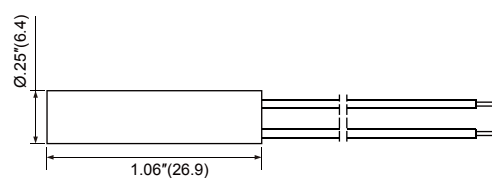
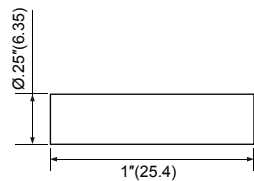

TAP-15

RECESSED CONTACTS

Outline Dimensions

Unit: inch(mm)

TAP-15 WG



Bare Rare Earth
(BT 3/8"×3/4")

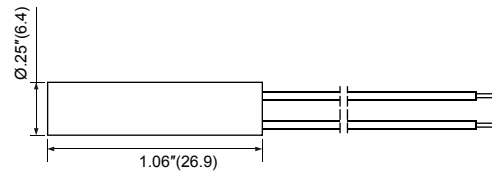
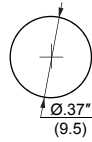
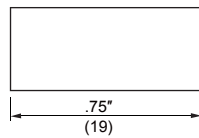

TAP-17C

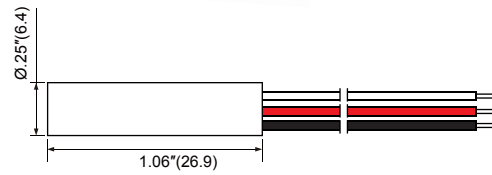
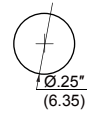
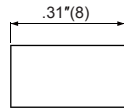

TAP-17C Wiring Diagram

